



# Installation Instructions / Care & maintenance

## Entrance Pull Handles - Verta

### Tools required

- Tape measure
- Soft pencil
- Level
- Ø 17 mm drill bit
- Power Drill
- Spanner
- Allen key (supplied)

### Instruction steps

#### 1. Unpack handle

Check hardware pack content:

- M8 x 75 mm bolts x2 (OR) M8 x 60 mm Screw x 2
- M6 x 12 mm Grub Screw x 2
- Washer x 2
- Allen Key x 1
- Instructions sheet

Note: Handles are supplied with two sets of screws:

- x2 M8 x 60mm screws, suitable for doors 30mm to 40mm thick
- x2 M8 x 75mm screws, suitable for doors up to 55mm thick

#### 2. Prepare door

If door is predrilled, go to step 3, otherwise follow the steps below. With a soft pencil, mark the centres of the holes (762mm) to be drilled.

Check alignment using a level.  
Drill holes 2 x Ø 17mm.

#### 3. Handle installation

**3a.** To install handles on the doors, install the screw and the washer supplied with the hardware pack, and assemble it as shown in the image on the right hand side.

**3b.** Place outer handle on the drilled holes of the door and push until is flush with the door surface and secure it in place with one hand.

**3c.** Secure the outer handle with the screw and washer assembled at 3a.

**3d.** Position inner handle over the screws on both ends and push until is flush with the door surface and secure with grub screws (supplied).

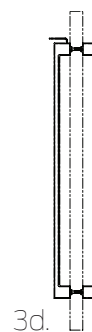
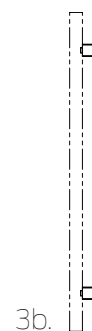
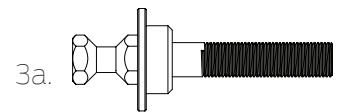
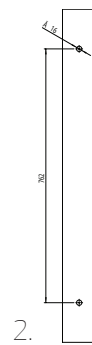
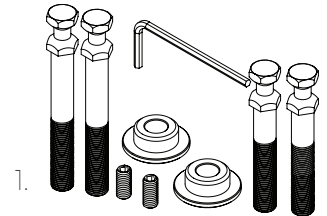



# Installation Instructions / Care & maintenance

## Entrance Pull Handles

### Cleaning and maintenance

Although stainless steel is very resistant to corrosion, factors exist that cause stainless steel to stain or discolour, impairing the overall look. This brown discolouration, also known as tea staining, does not affect the structural integrity or the longevity of the material and it can be controlled.

Any discolouration should be removed immediately or permanent discolouration and pitting of the surface could occur. In most cases, if attended to immediately, the product can be restored to its original condition.

The following are recommendations to prevent and/or remove discolouration:

- **Wash Regularly** – In coastal or caustic environments stainless steel finishes may tea stain if not washed regularly to remove salt. Cleaning involves washing with a potable, low chloride water or washing with a neutral detergent followed by rinsing with potable water. If products are not regularly washed, pits may develop and the surface may be permanently damaged.
- **Cleansing** – Most discolouration can be removed with a mild cleanser (Ajax, White Lily, Bon Ami etc...) or a specialist stainless steel cleanser (3M Stainless Steel Cleanser, Goddard's Stainless Steel Cleaner, Revere Ware Stainless Steel Cleanser etc...) and a non scratch cleaning sponge or cloth.

Apply potable clean water with the cleaning sponge and rub gently. If the mark does not shift, apply the specialist stainless steel cleanser and rub gently. An old toothbrush can be used to get into any difficult areas. The surface should then be thoroughly rinsed with potable clean water and buffed with a soft cloth.

NEVER rub across the grain as the finish may be spoiled, the stainless may lose its shine and the finish may pull threads from the cloth which may be difficult to remove.

NEVER use steel wool to clean stainless steel. Steel wool is usually made from carbon steel and the fragments left behind, as well as scratching the surface, will rust onto the stainless steel surface causing further damage. If a scourer is to be used, use a plastic scourer such as Scotchbrite or a stainless steel wool scourer.

#### Customer Service Details

##### Allegion (Australia) Pty Ltd

Phone: 1800 098 094  
Fax: 1800 098 095  
Email: [auinfo@allegion.com](mailto:auinfo@allegion.com)  
Website: [www.allegion.com.au](http://www.allegion.com.au)

##### Allegion (New Zealand) Limited

Phone: 0800 477 869  
Fax: 0800 477 868  
Email: [nzinfo@allegion.com](mailto:nzinfo@allegion.com)  
Website: [www.allegion.co.nz](http://www.allegion.co.nz)

